

Kælder

Samlet areal: 1094m²

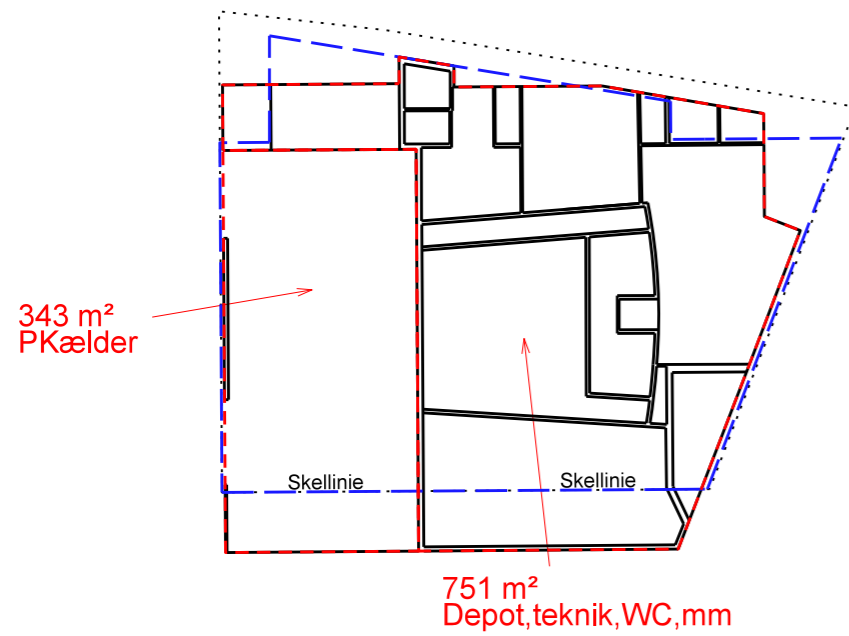

Stue

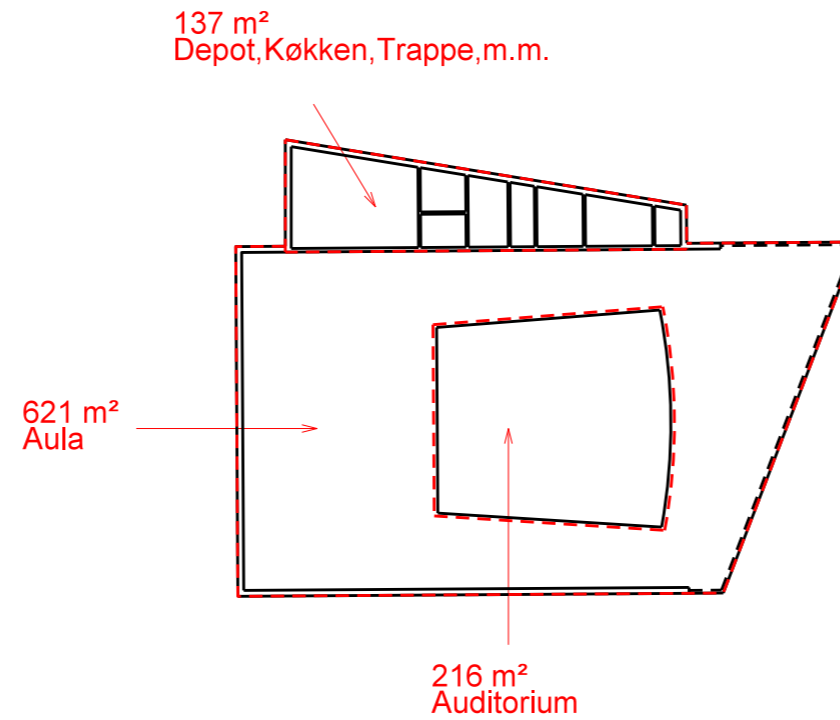

Samlet areal: 974m²

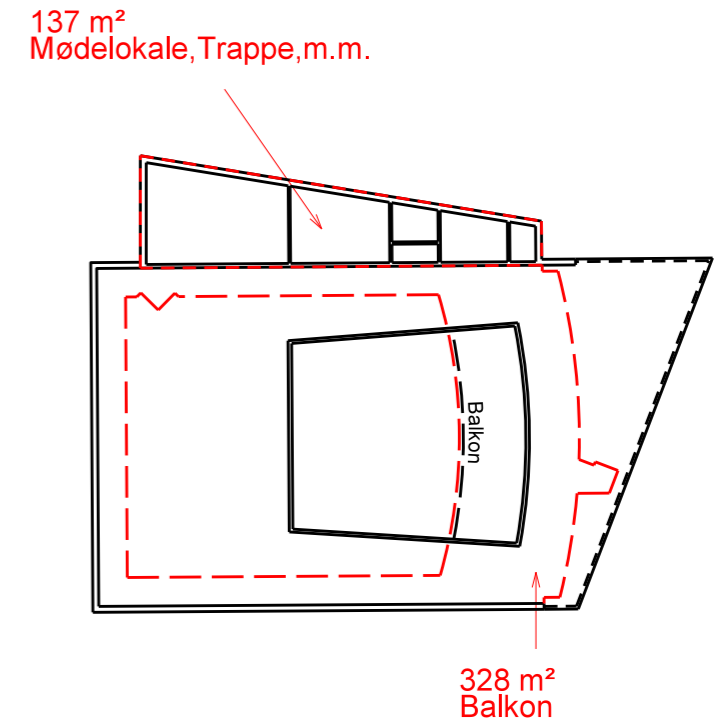

1.sal

Samlet areal: 465m²

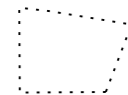

-  Skel
-  Stueplan
-  Arealer

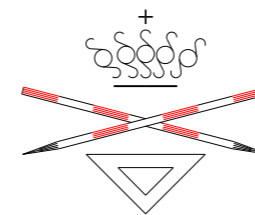
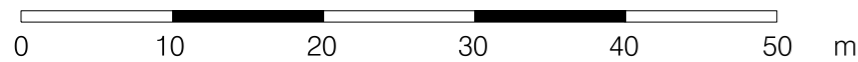

Landinspektør • firmaet
Bonefeld & Bystrup A/S
 Strandpromenaden 6 8700 Horsens
 Tlf. 76 28 60 60 Fax. 76 28 60 61
 post@landplan.dk www.bonefeld-bystrup.dk

Arealer vedr. Arkitektskolen
 Matr.nr. 933e Århus Bygrunde
 Nørreport 20, 8000 Århus C
 Århus Kommune

Fil 43485sit		Dato	Init.
Målt	03.09.18	sbe	
Tegnet	18.09.18	sbe	
J nr	Tegn. udg.	Dato	Kotesystem
43485	b	10.04.2019	DVR90
		Målforshold	1:500

Godkendt

landinspektør